

## PSHL3-Z3

**Two Layer on Ground and  
One Layer In the Pit  
Motor Chain & Stacker  
Parking Equipment  
Complies to AS 5124:2017**



# PSHL3-Z3

2 Layer On Ground & 1 Layer In The Pit Motor & Chain

## Introduction

- The combination of two floors above ground and one underground floor, the upper and lower floors are lift platform, and the middle floor is connected to the ground by traversing platform.
- A parking space can accommodate up to 3 cars, providing more space to create more parking space.
- The operation is simple, the car is easily accessible making this product convenient and safe, as well as easy to use and maintain.
- Customizable to customer preference.



- ① Upper lift platform
- ② Transverse platform
- ③ Lower lift platform
- ④ Safety hook prevents platform plate from falling.

⑤ Garage doors can be installed to achieve compliance to AS 5124:2017



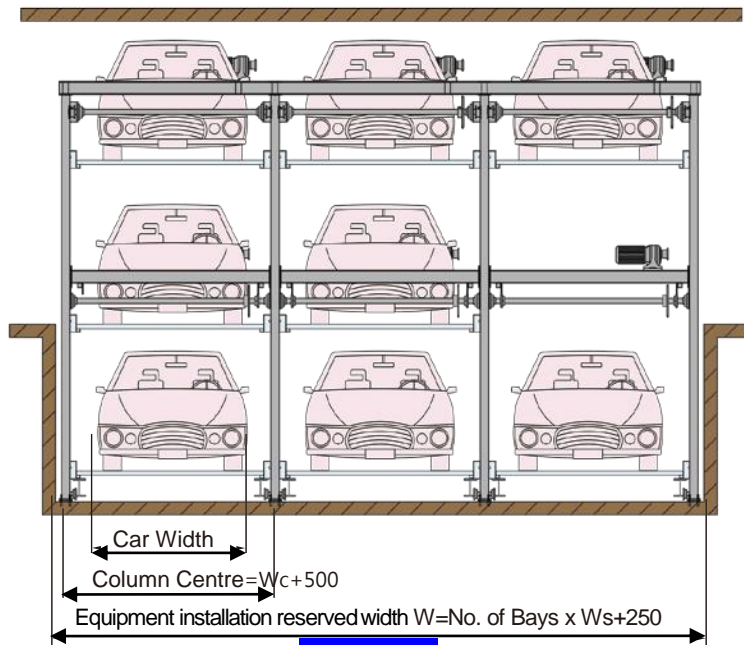

**Front View**

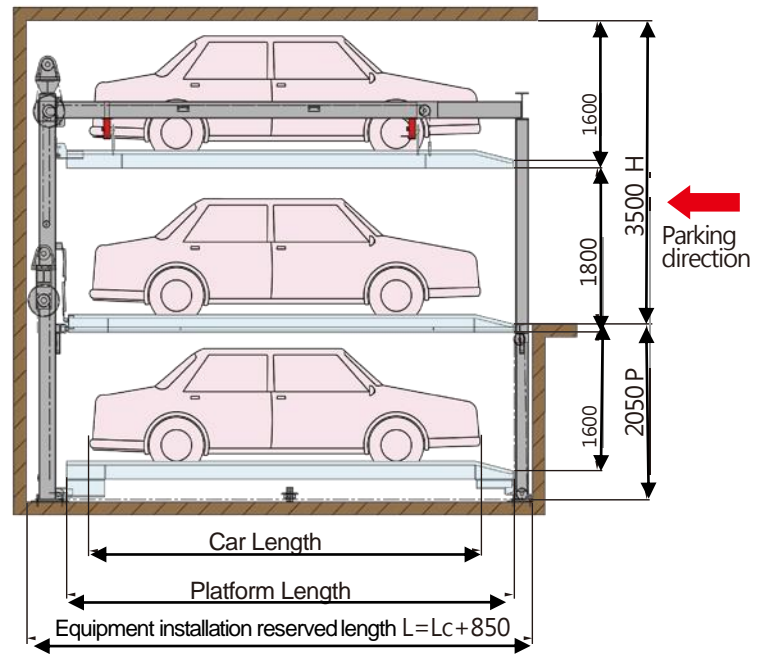

**Side View**

## Specifications



Name		PSHL3-Z3			
Type		Above-ground two-layer and underground one-layer lift-sliding			
Classification		Small vehicle	Medium vehicle	Large vehicle	
Maximum Car dimensions	Width (mm)	1800	1900	2000	
	Length (mm)	4600	5000	5300	
	Height (mm)	1450	1550	1550	
	Weight of platform (kg)	2000	2000 / 2500	2000 / 2500	
Column center	Ws (mm)	Width of Bay = Car Width + 500			
Equipment installation reserved width		Number of parking units × (column center + 250)			
Equipment installation reserved length		Length of car = Car Length + 850			
Overall height limit under the beams		3500 H (mm)			
Pit depth		2050 P (mm)			
Lifting speed		3.9 M/min			
Transverse sliding speed		6.9 M/min			
Installation		TBC			
Drive mode		Motor and chain			
Operation method		Press button or swiping card			
Parking method		Reverse parking			

## Safety Devices

### Emergency Stop Switch

In case of emergency or malfunction, the emergency stop button can be pressed to immediately stop the machine.

### Transverse slide Sensor

The transverse positioning of the platform is precise to ensure correct machine function.

### Caution Light

When in operation, the caution light will flash to alert other drivers of machine operation status.

### Upper/Lower Limit Sensor

The vertical positioning of the platform is precise to prevent skid overtravel.

### Overcurrent protection device

If the motor is overloaded during operation, the power to the motor is automatically cut off.

### Vehicle Positioning Device

Vehicle positioning system to ensure safe machine use

### Operating time limit device

If the platform doesn't reach the set destination within the programmed time, the power to the motor is automatically cut off.

### Front and rear car length photoelectric sensor

Photo electric sensors installed to ensure correct vehicle is parked for this machines application.

### Emergency braking system

In the event of a power interruption, the platform will automatically halt, preventing any vehicle from lowering.

## Keypad

Set the power button to "On to call the car or press the control button to call the car.

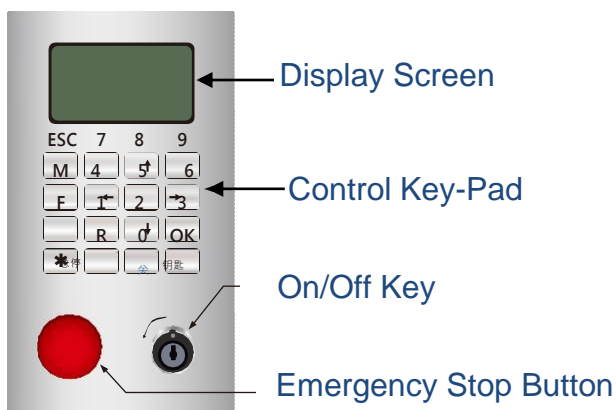

## Surface treatment

Structure: Powder Coating / Hot Dip Galvanizing

Platform: Powder Coating / Hot Dip Galvanizing

Corrugated steel sheet: Galvanized steel plate

## Standard paint color

(Color code)1-38  
★ (Medium grey)

- The printed and actual colors may be slightly different.
- Other colors are available upon request.