

# TRUE BALANCE

---

A.B.N 76 607 491 758

Postal address: 4/5 Supertron Court, Laverton North, Vic 3026

Phone: 1300 214 456

Email: [admin@truebalance.com.au](mailto:admin@truebalance.com.au)

## PJSL2-Z1

**Above-Ground Two High Motor & Chain Stacker  
Parking Equipment  
Complies to AS 5124 : 2017**



# PJSL2-Z1

## Above-Ground Two High Motor & Chain Stacker

### Introduction

- There are many available combinations of above-ground double-layer parking systems, which can be arranged according to customer specification and application.
- They can be built in open spaces, as well as basements which can more effectively utilize available real estate to create better parking solutions.
- The car is easily accessible making this product convenient and safe, as well as easy to use and maintain.
- Customizable to customer preference.



1 Lift platform

2 Separate bar

3 Safety hook prevents the platform plate from falling.

4 Full length Garage Doors Installed to achieve compliance to AS5124



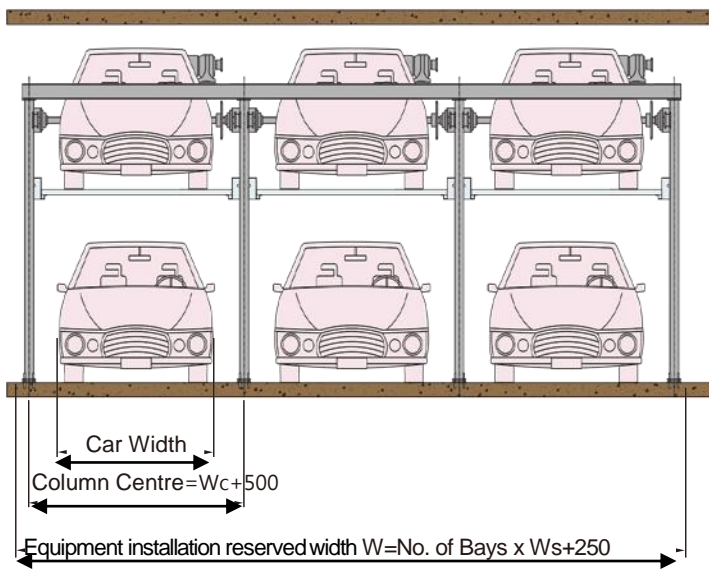

Front View

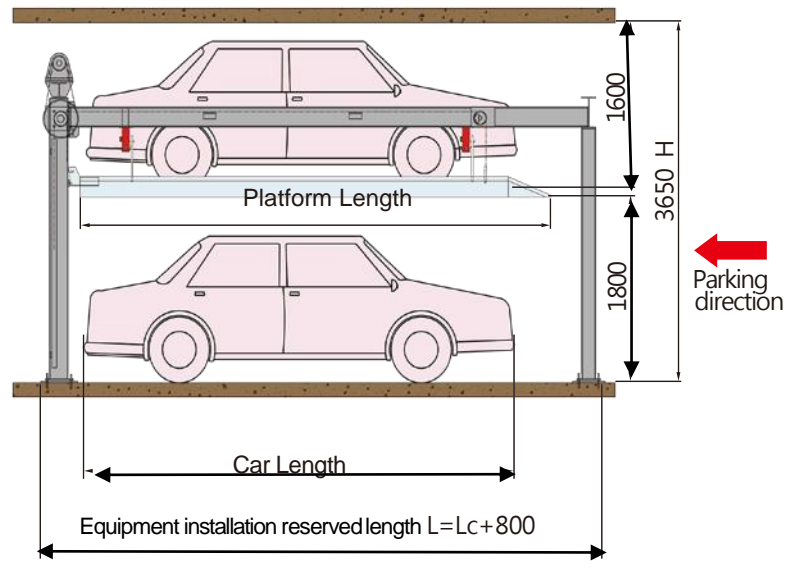

Side View

## Specifications



Name		PJSL2-Z1			
Type		Above-ground two height stacker			
Classification		Small vehicle	Medium vehicle	Large vehicle	
Maximum Car dimensions	Width	(mm)	1800	1900	2000
	Length	(mm)	4600	5000	5300
	Height	(mm)	1450	1550	1550
	Weight of platform (kg)		2000	2000 / 2500	2000 / 2500
Column center	Ws (mm)	Width of Bay = Car Width +500			
Equipment installation reserved width		Number of parking units × (column center + 250)			
Equipment installation reserved length		Length of car = Car Length +800			
Overall height limit under the beams		3500 H (mm)			
Lifting speed		3.9 M/min			
Installation		TBC			
Drive mode		Motor and chain			
Operation method		Press button or swiping card			
Parking method		Reverse parking			

## Safety Devices

### Emergency Stop Switch

In case of emergency or malfunction, the emergency stop button can be pressed to immediately stop the machine.

### Emergency braking system

In the event of a power interruption, the platform will automatically stop, preventing the skid from lowering.

### Caution Light

When in operation, the caution light will flash to alert other drivers.

### Upper Limit Sensor

Vertical positioning system for accurate vehicle placement.

### Overcurrent protection device

If the motor is overloaded during operation, the power to the motor is automatically cut off.

### Vehicle Positioning Device

The car needs to be parked within the set parking limitation in order to not exceed the capacity of the equipment.

### Operating time limit device

Built in safety system to ensure machine safety function as per AS 5124 - 2017

## Keypad

Set the power button to "On" to call the car or press the control button to call the car.

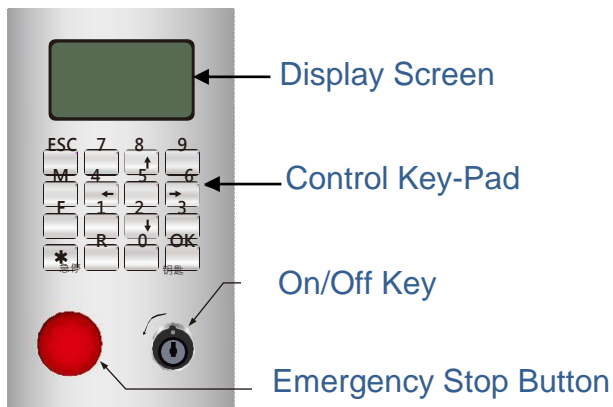

## Surface treatment

Structure: Powder Coating / Hot Dip Galvanizing

Platform: Powder Coating / Hot Dip Galvanizing

Corrugated steel sheet: Galvanized steel plate

## Standard paint color



- The printed and actual colors may be slightly different.
- Other colors are available upon request.